

AGENDA

2024 HARRY JEROME INDOOR GAMES TECHNICAL MEETING

Date: Saturday, February 3, 2024

Time: 8:45 AM

Location: Richmond Olympic Oval – Room 2029

Item	Title	Description	Time	Lead
	Welcome		1 min	Larry
	Introductions	> Round the table introductions	1 min	Larry
	Review Agenda	> Confirm all topics are covered + additions	1 min	Larry
	Maps (Facility and Tables)	> Review Facility and Table Maps (attached) > Start lines and staggers (attached) > 2 athlete check-in stations: 1 for Oval/HJ/SP + 60m/60mH	2 min	Larry
	Competition Schedule and Pace of Meet	> Review of Schedule (attached) > Pace of Meet	2 min	Larry
	Officials	> Jury of Appeal: Larry Blaschuk, Carl Savage + 1 of Referees as needed > Referees: Track = _____ (Oval) _____ (Straight) /Field = _____	30 sec	Larry
	Scoring	> Review process > The Eaton Cup (Club Aggregate Winner) > Outstanding Performances by Division (U16/U18/ Open/Masters – M/W) > Points awarded for first 5 places: 6-4-3-2-1	1 min	Larry
	Paper Flow	> Finish line(s) > Results > Announcing > Scoring Table > Posting (Wall) > Awards	1 min	Larry
	Field Events	> Number of attempts > Throwing implements are provided: MG 3 kg, YW 3 kg, OW 4 kg, MB 4 kg, YM 5 kg and OM 7.26 kg > HJ: Women: 1m20 + Men: 1m35, both up by 5 cms	30 sec	Larry
	Spike Checks	> If spikes are worn, only the following spikes will be allowed for use on the new Pulastic flooring: Omni-Lite 5mm Ceramic Indoor Pyramid spike and Omni-Lite 7mm Ceramic Indoor Pyramid spike > The use of any other type or longer length of spike is prohibited and will be strictly enforced	1 min	Larry
	Start Rule	> Review rule > Track Zone starting blocks will be the only ones utilized	1 min	Larry
	Relay Rules	> Review rules	1 min	Larry

Numbers	<ul style="list-style-type: none"> ➤ Hip numbers (1-5) and front name bibs ➤ Hip = stick-type, assigned and distributed at track 	1 min	Larry
Start Lists	<ul style="list-style-type: none"> ➤ Review entries and lane assignments ➤ Scratches or additions 	5 min	Larry
Q's + A's	<ul style="list-style-type: none"> ➤ Questions from the floor 	1 min	Larry
	Total meeting time	20 min	

2024 HARRY JEROME INDOOR GAMES

SCHEDULES

Available at www.harryjerome.com/events

START LINES and STAGGERS

- 60m*, 60mH* and 300m – run in lanes all the way (300 has 3-curve staggered start)
- 600m – 2-curve staggered start in lanes; break in after second curve
- 1000m – start on single or double curved line; break in when clear; 8 runners max
- 1200m/1500m - start on single or double curved line; break in when clear; 9 runners max
- 4 x 200m – 3-curve staggered start in lanes; break in after third curve (20m exchange zone)
- 1500m RW – start on single or double curved line; break in when clear; 24 walkers max
- 800m RW – start on single or double curved line; break in when clear; 24 walkers max

*run on straightaway

will be available at www.harryjerome.com/events

FACILITY MAP

2019 Harry Jerome Indoor Games - Site Plan

Last Reviewed - January 26, 2018

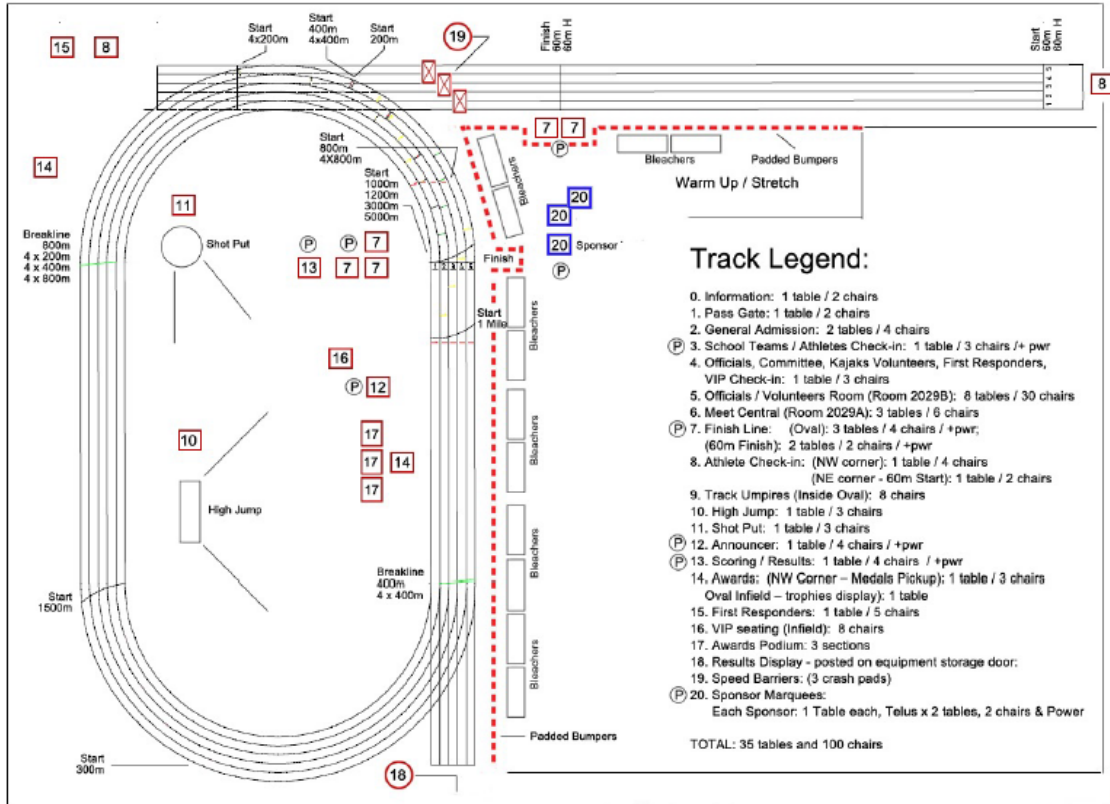

Track Legend:

- 0. Information: 1 table / 2 chairs
 - 1. Pass Gate: 1 table / 2 chairs
 - 2. General Admission: 2 tables / 4 chairs
 - 3. School Teams / Athletes Check-in: 1 table / 3 chairs / + pwr
 - 4. Officials, Committee, Kajaks Volunteers, First Responders, VIP Check-in: 1 table / 3 chairs
 - 5. Officials / Volunteers Room (Room 2029B): 8 tables / 30 chairs
 - 6. Meet Central (Room 2029A): 3 tables / 6 chairs
 - 7. Finish Line: (Oval): 3 tables / 4 chairs / + pwr; (60m Finish): 2 tables / 2 chairs / + pwr
 - 8. Athlete Check-in: (NW corner): 1 table / 4 chairs (NE corner - 60m Start): 1 table / 2 chairs
 - 9. Track Umpires (Inside Oval): 8 chairs
 - 10. High Jump: 1 table / 3 chairs
 - 11. Shot Put: 1 table / 3 chairs
 - 12. Announcer: 1 table / 4 chairs / + pwr
 - 13. Scoring / Results: 1 table / 4 chairs / + pwr
 - 14. Awards: (NW Corner - Medals Pickup): 1 table / 3 chairs (Oval Infield - trophies display): 1 table
 - 15. First Responders: 1 table / 5 chairs
 - 16. VIP seating (Infield): 8 chairs
 - 17. Awards Podium: 3 sections
 - 18. Results Display - posted on equipment storage door
 - 19. Speed Barriers: (3 crash pads)
 - 20. Sponsor Marquees: Each Sponsor: 1 Table each, Telus x 2 tables, 2 chairs & Power
- TOTAL: 35 tables and 100 chairs

